

RESOLUTION NO. 2763

A RESOLUTION of the Port Commission of the Port of Seattle providing for the amendment of Unit 18 of the Port's existing Comprehensive Scheme of Harbor Improvements applicable to Sea-Tac International Airport to add real property located at the westerly portion of Washington Memorial Park Cemetery.

WHEREAS, the voters of King County, pursuant to the provisions of enabling legislation adopted by the Legislature of the State of Washington, Chapter 92, Laws of 1911, RCW 53.040.101, authorized and approved at a Special Election held in King County on the 5th day of September, 1911, the formation of a Port District coextensive with King County to be known as the Port of Seattle, and;

WHEREAS, the Port of Seattle was thereupon established as a Port District and has since been and now is a duly authorized and acting Port District of the State of Washington, and;

WHEREAS, the original Comprehensive Scheme of Harbor Improvements of the Port of Seattle was fixed in Resolution No. 17 of the Port Commission and was ratified by the qualified electors of the Port District at a special election held therein on March 5, 1912, and;

WHEREAS, Unit 18 of the Comprehensive Scheme of Harbor Improvements was heretofore adopted by the Port Commission of the Port of Seattle by Resolution No. 1194 and ratified by the qualified electors of the Port District at a special election held therein on November 5, 1946 which unit has been subsequently amended in the manner provided by law, and;

WHEREAS, an official Public Hearing was held on June 26, 1979 on the question of whether or not Unit 18 of the Port's Comprehensive Scheme of Harbor Improvements applicable to Sea-Tac International Airport should be enlarged to include certain additional real property (hereinafter referred to as the "Proposed Amendment"), and;

WHEREAS, notice of said Public Hearing and of the Proposed Amendment to be considered at said meeting was published in a daily newspaper of general circulation in the Port District on June 15, 1979 as provided by law, and;

WHEREAS, the Port heard from all persons desiring to speak at said Public Hearing with regard to said Proposed Amendment, including all persons who desired to speak on the environmental aspects of said Proposed Amendment, and;

WHEREAS, the members of the Port Commission at said Public Hearing viewed maps and other data indicating the properties proposed to be added to Unit 18 of the Comprehensive Scheme, which maps and other data were and are now on file in the office of the Port Commission, and;

WHEREAS, the members of the Port Commission have discussed and considered the Proposed Amendment in light of the comment by members of the public at the Public Hearing.

NOW, THEREFORE, BE IT RESOLVED that Unit 18 of the Comprehensive Scheme of Harbor Improvements of the Port of Seattle be enlarged by the addition of certain real property in the County of King, State of Washington, legally described in Exhibit A attached hereto and by this reference incorporated herein and shown on Port Drawing No. PM-STIA-124 attached hereto and incorporated herein by this reference as Exhibit B.

ADOPTED by the Port Commission of the Port of Seattle at a regular meeting held this 26th day of June, 1979, and duly authenticated in open session by the signatures of the Commissioners and the seal of the Commission.



Port Commissioners

EXHIBIT "A" of RESOLUTION No. 2763

THAT PORTION OF THE EAST HALF OF THE WEST HALF OF THE NORTHEAST QUARTER OF SECTION 28, TOWNSHIP 23 NORTH, RANGE 4 EAST, W.M., IN KING COUNTY, WASHINGTON, BEING WITHIN THE WEST HALF OF SECTION 19, WASHINGTON MEMORIAL PARK, PER PLAT RECORDED IN VOLUME 52 OF PLATS, PAGE 49 AND SECTION 20, WASHINGTON MEMORIAL PARK, PER PLAT RECORDED IN VOLUME 53 OF PLATS, PAGE 81, AND SECTION 21, WASHINGTON MEMORIAL PARK, PER PLAT RECORDED IN VOLUME 73 OF PLATS, PAGE 14, IN KING COUNTY, WASHINGTON, DESCRIBED AS FOLLOWS:

BEGINNING AT THE SOUTHWEST CORNER OF SAID SUBDIVISION; THENCE NORTH $1^{\circ}31'33''$ EAST ALONG THE WEST LINE THEREOF A DISTANCE OF 1,809.39 FEET TO THE SOUTH LINE OF THE PLAT OF NORTH BOW LAKE TRACTS ACCORDING TO VOLUME 48 OF PLATS, PAGE 84, RECORDS OF KING COUNTY; THENCE SOUTH $89^{\circ}09'56''$ EAST ALONG SAID SOUTH LINE A DISTANCE OF 303.27 FEET; THENCE SOUTH $1^{\circ}26'04''$ WEST A DISTANCE OF 1,809.30 FEET TO THE SOUTH LINE OF SAID SUBDIVISION; THENCE NORTH $89^{\circ}10'34''$ WEST A DISTANCE OF 306.16 FEET TO THE POINT OF BEGINNING. ALL BEARINGS ARE LAMBERT ACCORDING TO THE 1973 N.G.S. UNADJUSTED SURVEY.

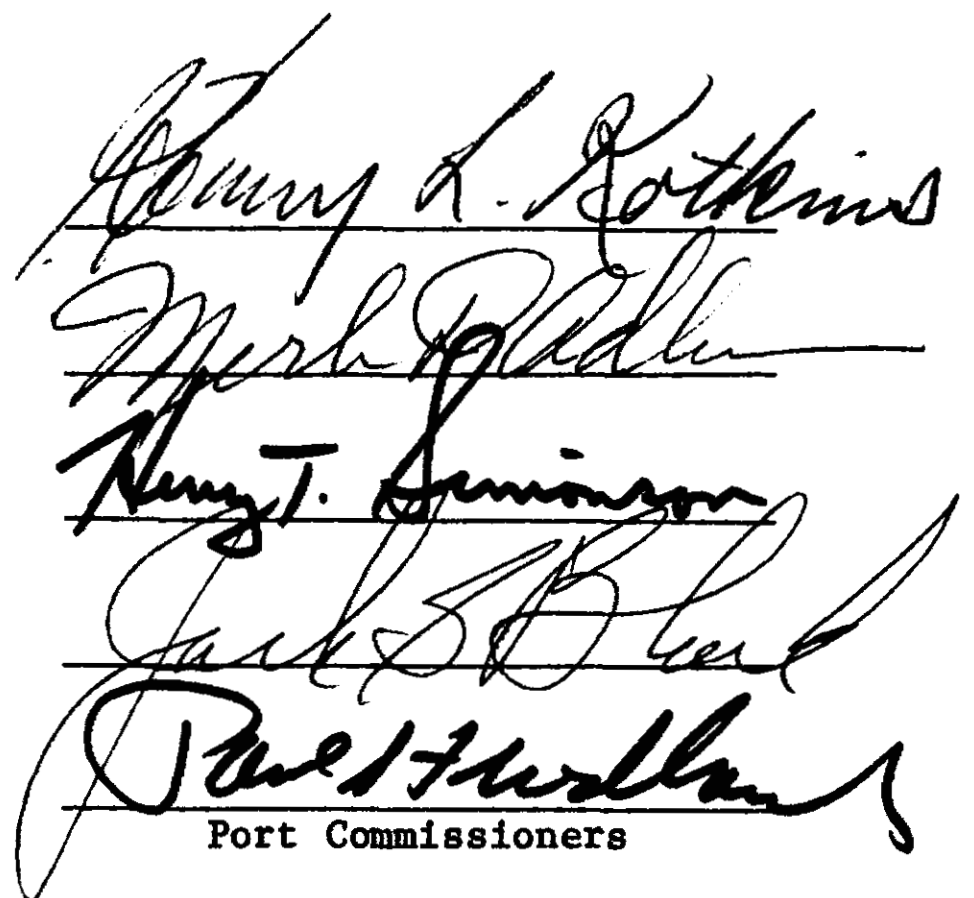
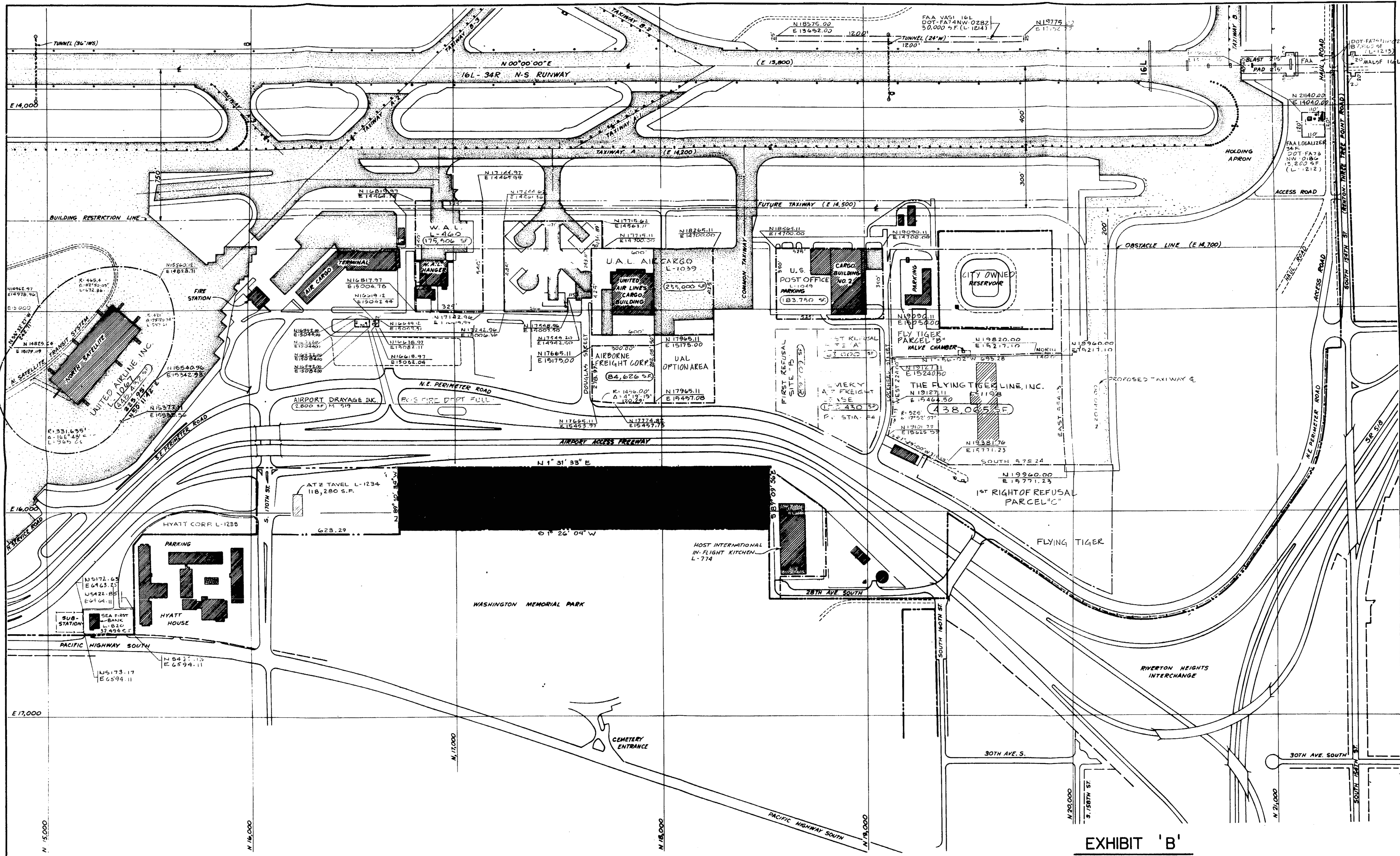

EXHIBIT 'B'

DESIGN ENGINEER		DESIGNER		DATE		CHECKED BY		APPROVED BY	
J. Fisher	J. Fisher	J. Boyd	L. Hoff	June 6, 1979					

REVISIONS			
NO.	DATE	BY	DESCRIPTION

PORT OF SEATTLE SEATTLE-TACOMA INTERNATIONAL AIRPORT		WORK ORDER NO. D-2701
RESOLUTION 2763		CONSULTANT'S NO. PORT OF SEATTLE NO. PM-STIA-124

